

## BEAM TYPE LOADCELL

### Ideal for incorporating into semiconductor manufacturing equipment! Siloxane-free loadcell

At a manufacturing site of semiconductors, an equipment which does not let silicone resin generate siloxane is essential.

Taking into account the applications around silicon wafer, the Teflon sheathed cable is used.

#### Specifications

Model	UWR-10N
Rated capacity	10 N
Rated output	Approx. 0.5 mV/V
Safe overload	300% R.C.
Zero balance	±20% R.O.
Non-linearity	0.03% R.O.
Hysteresis	0.03% R.O.
Repeatability	0.02% R.O.
Compensated temperature range	0 ~ +50℃
Safe temperature range	-10 ~ +70℃
Temperature effect on zero	0.5% R.O./10℃
Temperature effect on span	0.2% R.O./10℃
Input resistance	Approx. 1000 Ω
Output resistance	Approx. 1000 Ω
Recommended excitation voltage	5 V
Insulation resistance (DC 50 V)	1000 MΩ or more
Cable	φ2 4 conductor Teflon sheathed cable (3 m) Cable end: 5 wires
Weight	Approx. 40 g (not including cable)
Loadcell material	Aluminum alloy



Siloxane-free Teflon sheathed cable

BEAM TYPE LOADCELL

# UWR

#### Example of use

- Gripping force management of wafer transporting robot
- Pressing force management at wafer lapping
- Load control of chip mounter
- Pressing force management at wire bonding
- Adhesive force measurement of gas, liquid, jelly etc.

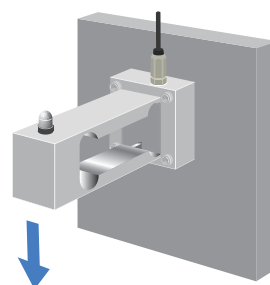

#### Wiring diagram

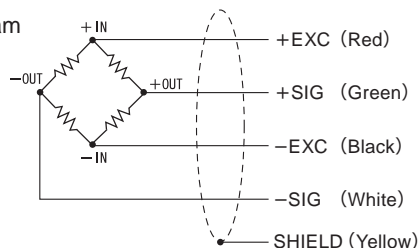

#### External dimension

Unit:mm

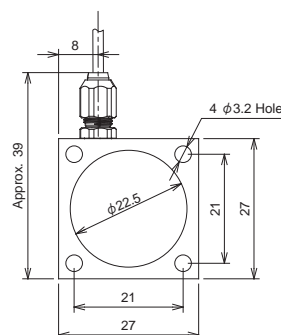
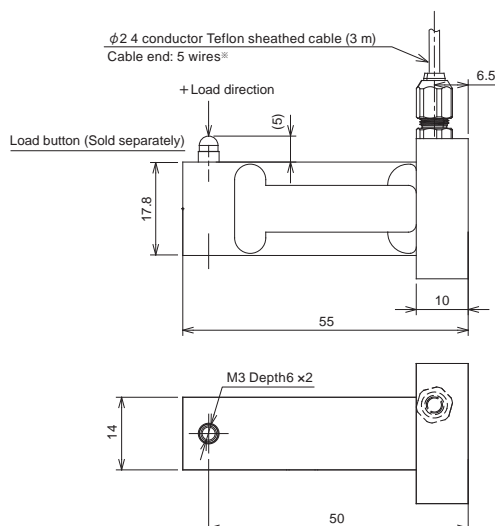

※Connector can be attached to the cable according to your requests.

Model	Deflection at rated	Natural frequency
UWR-10N	0.04 mm	2.5 kHz

Specifications, appearance, and design may be changed for improvement without prior notice. Please check with us when ordering.

### Unipulse Corporation

International Sales Department 9-11 Nihonbashi Hisamatsu-cho, Chuo-ku, Tokyo 103-0005  
Tel: +81-3-3639-6121 Fax: +81-3-3639-6130