

PW6C

SINGLE POINT TYPE LOAD CELL



IP67

Specifications

Model	PW6C-5KG, PW6C-10KG, PW6C-20KG, PW6C-30KG, PW6C-40KG	
Rated capacity	5, 10, 20, 30, 40	kg
Rated output	2.2±0.2	mV/V
Safe overload	150	%R.C.
Maximum safe side overload	300	%R.C.
Zero balance	0 ± 0.12	mV/V
Non-linearity	0.0166 typ.	%R.O.
Hysteresis	0.0166 typ.	%R.O.
Compensated temperature range	-10 to +40	°C
Safe temperature range	-10 to +50	°C
Temperature effect on zero	0.0140 (5/10/20kg), 0.0093 (30kg), 0.0175 (40kg)	%R.O./10K
Temperature effect on span	0.0175 (+20 to +40°C), 0.0117 (-10 to +20°C)	%R.O./10K
Input resistance	300 to 500	
Output resistance	300 to 500	
Recommended excitation voltage	1 to 12	V
Insulation resistance	2000 or more	M
Degrees of protection	IP67	
Cable	6 conductor shield cable 2m End treatment 7 leads.	
Load cell material	Aluminum	

Application Example

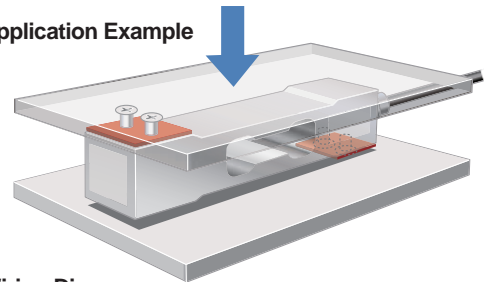

Wiring Diagram

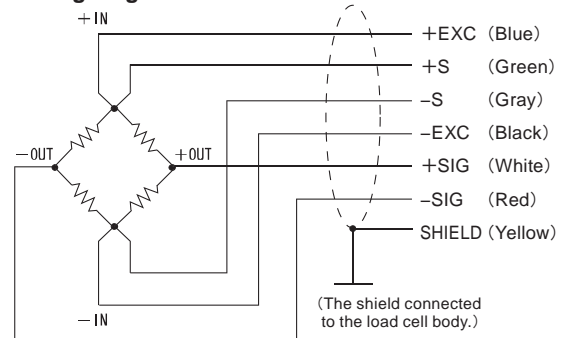

External dimension

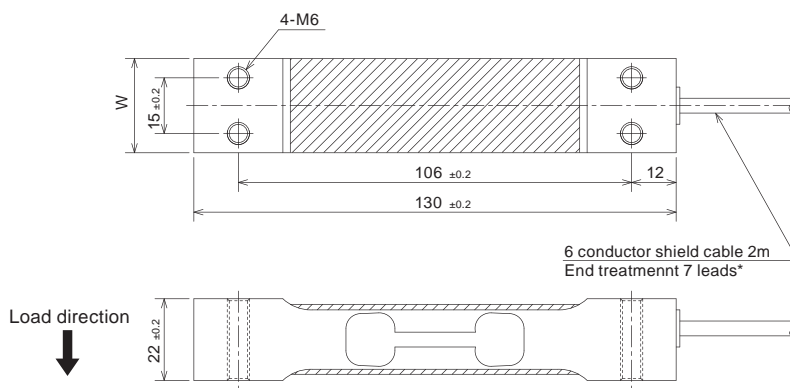

Model	Deflection at rated	Natural frequency	Maximum off center distance	Maximum platform size	Weight	W
PW6C-5KG	0.5mm or less	225Hz	100mm	300x300mm	0.25kg	25.4±0.2
PW6C-10KG		331Hz				
PW6C-20KG		473Hz				
PW6C-30KG		573Hz				
PW6C-40KG		606Hz				